

HOW TO ADJUST THE TABLE:

General Operation:

Press and hold the DOWN or UP arrow button to move the table to the desired height.

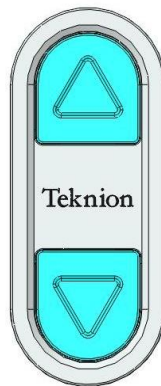

SETUP INSTRUCTIONS AND TROUBLESHOOTING TIPS

Initialization Procedure:

When you are using the table for the first time, you must INITIALIZE the table legs.

- Adjust the table to the lowest position and release the switch.
- Press and hold the DOWN button for 10 seconds. The legs should move up and down a small distance to indicate that the command has been received.
- Adjust the table to the highest position and back down to the lowest position twice in order to establish the full range of the table. The table is now ready for normal use.

Troubleshooting:

- If the table legs become un-level you must REINITIALIZE the system as described above.
- Ensure there are no obstructions in either the up or down direction.
- If the legs are not operating properly, it may be necessary to press the DOWN button twice to start the initialization process.

Monthly Maintenance:

- It is recommended that the table be REINITIALIZED once every month.

LVWR7/LVWR9 ASSEMBLY INSTRUCTIONS

STEP # 1

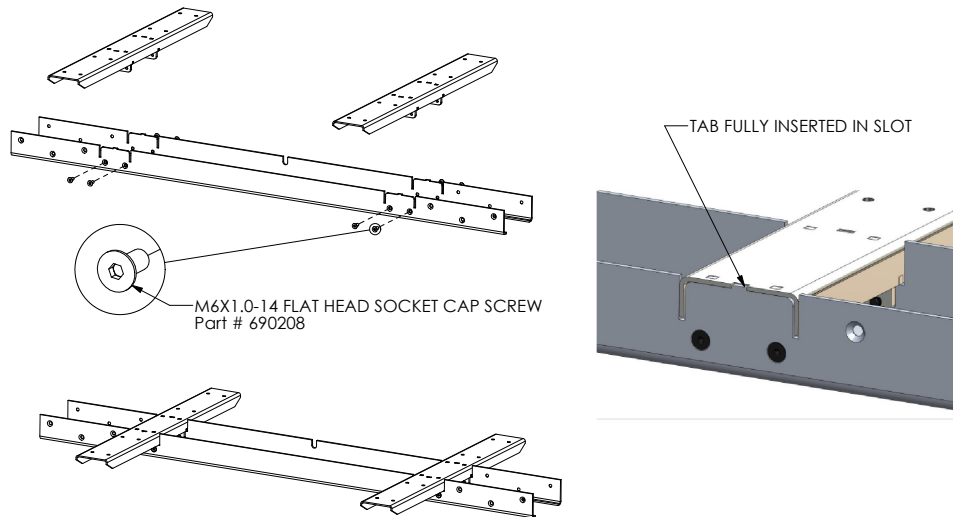

TOOLS REQUIRED: 4 mm HEX KEY

PARTS REQUIRED FOR STEP # 1

PART #	DESCRIPTION	QTY.
690208	M6X1.0-14 FLAT HEAD SOCKET CAP SCREW	8

STEP #2

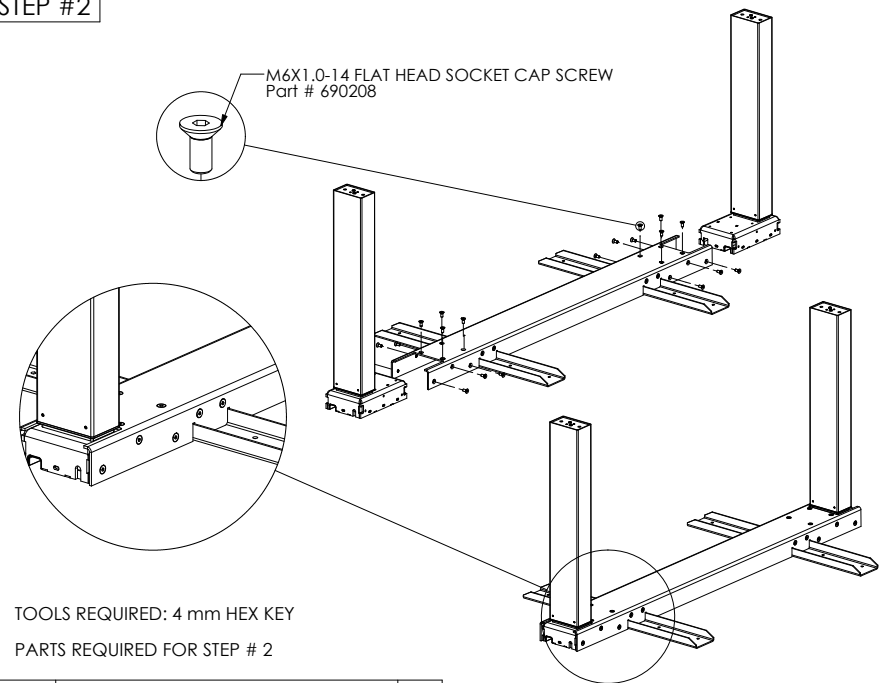

TOOLS REQUIRED: 4 mm HEX KEY

PARTS REQUIRED FOR STEP # 2

PART #	DESCRIPTION	QTY.
690208	M6X1.0-14 FLAT HEAD SOCKET CAP SCREW	20

STEP # 3

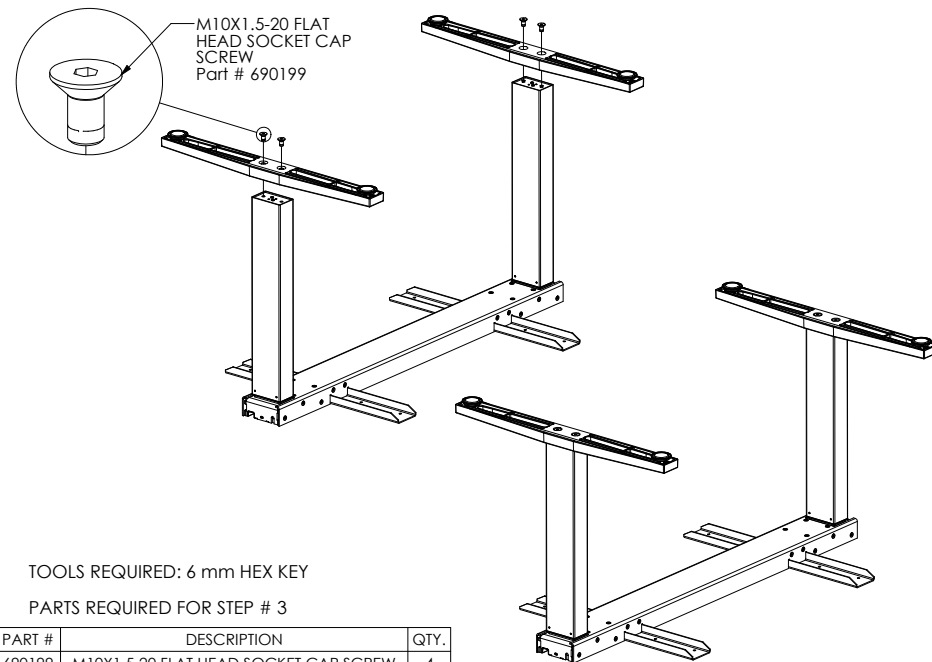

TOOLS REQUIRED: 6 mm HEX KEY

PARTS REQUIRED FOR STEP # 3

PART #	DESCRIPTION	QTY.
690199	M10X1.5-20 FLAT HEAD SOCKET CAP SCREW	4

STEP # 4

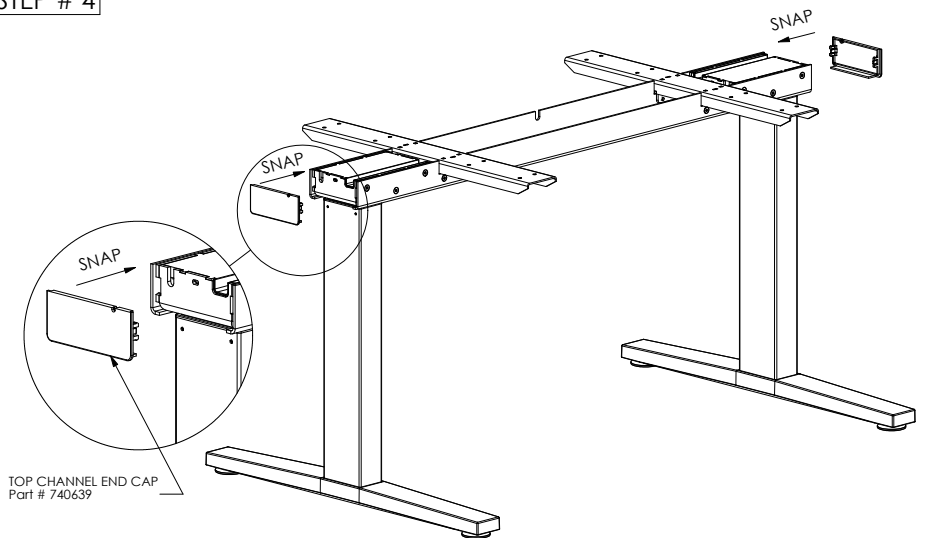

NO TOOLS REQUIRED

PARTS REQUIRED FOR STEP # 4

PART #	DESCRIPTION	QTY.
740639	TOP CHANNEL END CAP	2

LVWR7/LVWR9 ASSEMBLY INSTRUCTIONS

STEP # 5

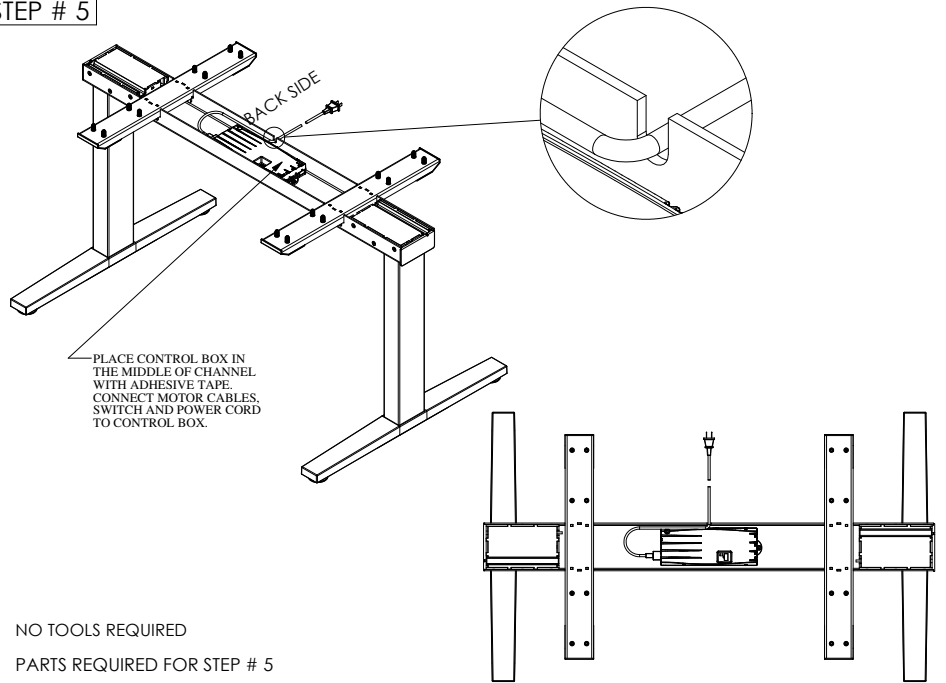

PART #	DESCRIPTION	QTY.
55-COMPACT-2-TEK-US-XX	CONTROL BOX	1
P-55-LOG-CBL-PWK-US-SJT	CABLE 3 POLE USA WITH EARTHING	1

STEP # 6

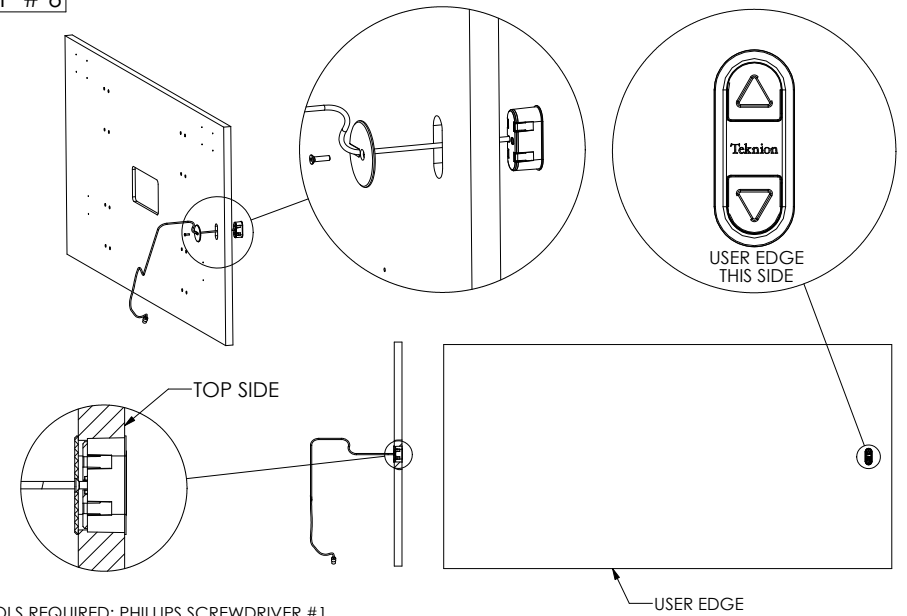

PART #	DESCRIPTION	QTY.
P-HSC-TEK-OD-2	CUSTOM TEKNION SWITCH INCL. ADAPTER CABLE	1

STEP # 7

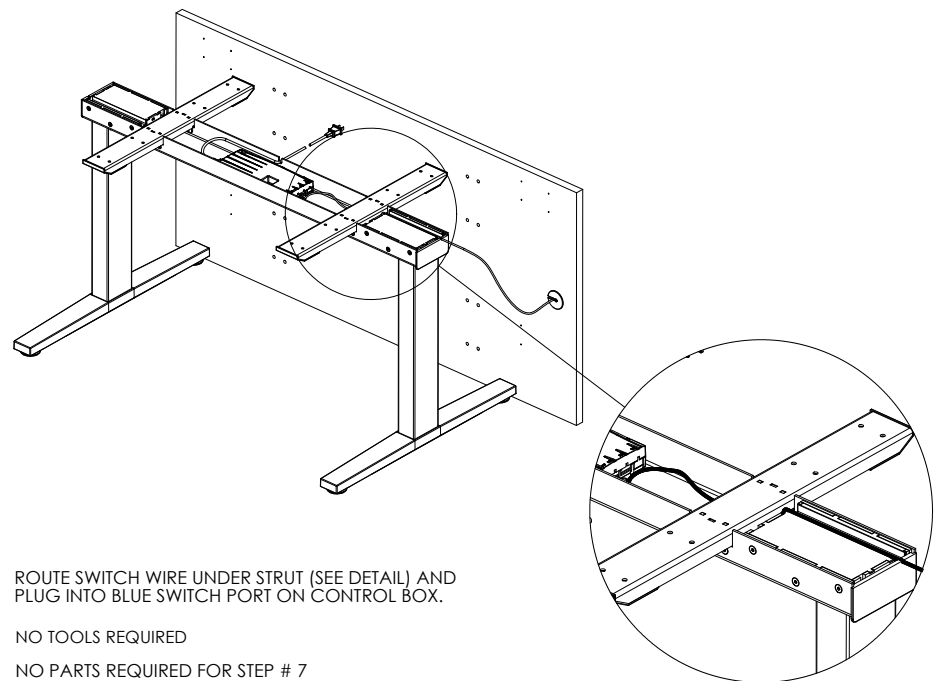

STEP # 8

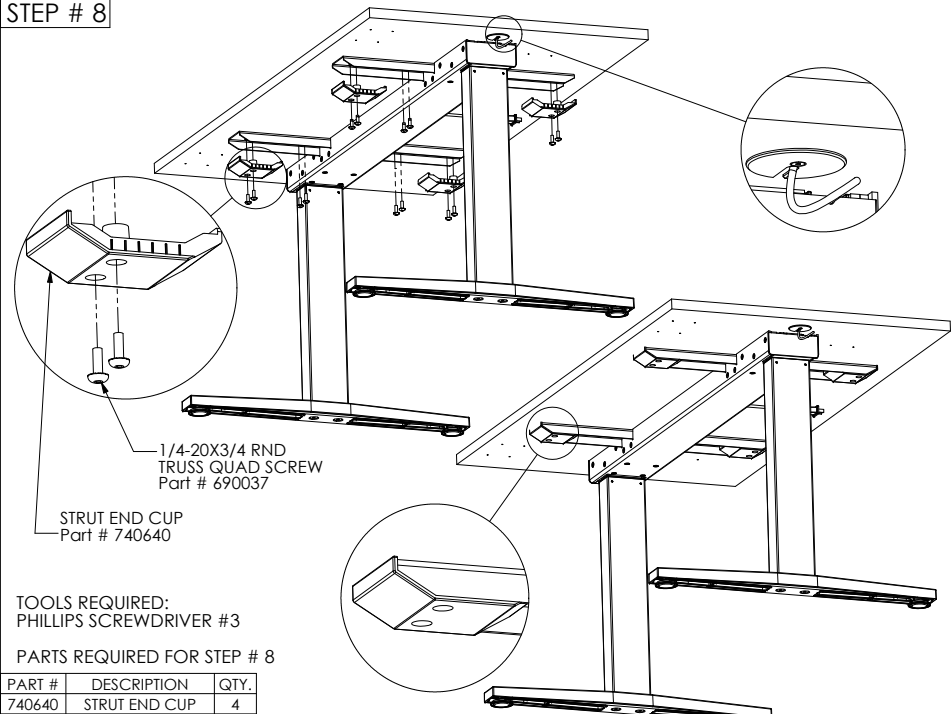

PART #	DESCRIPTION	QTY.
740640	STRUT END CUP	4
690150	1/4-20X5/8 SCREW	16